

INDICE CATEGORICO CATEGORIC INDEX	pag. 2	A
INDICE ANALITICO ANALYTIC INDEX	pag. 4	B
CONDIZIONI DI VENDITA SALES CONDITIONS	pag. 10	C
MAGGIORAZIONI PER IMPIANTI SPECIALI EXTRA CHARGES FOR KEYING ARRANGEMENTS	pag. 12	D
CHIAVI KEYS	pag. 15	1
CILINDRI CYLINDERS	pag. 19	2
MOSTRINE E PROTEZIONI PER CILINDRO ESCUTCHEONS AND CYLINDER PROTECTIONS	pag. 25	3
SERRATURE PER PORTE BLINDATE LOCKS FOR ARMOURED DOORS	pag. 31	4
SERRATURE DA INFILARE CON CHIAVI A DOPPIA MAPPA MORTICE LOCKS WITH DOUBLE BITTED KEYS	pag. 71	5
SERRATURE DA INFILARE A CILINDRO MORTICE LOCKS WITH CYLINDER	pag. 77	6
SERRATURE PER SERRAMENTI IN ALLUMINIO LOCKS FOR ALUMINIUM FRAMES	pag. 85	7
SERRATURE PER SERRAMENTI IN FERRO LOCKS FOR IRON FRAMES	pag. 97	8
SERRATURE PER PORTE E CANCELLI SCORREVOLI LOCKS FOR SLIDING DOORS AND GATES	pag. 103	9
SERRATURE PER PORTE E SERRANDE BASCULANTI ROLLER SHUTTER LOCKS	pag. 107	10
CHIUSURE PER CABINE ELETTRICHE LOCKS FOR ELECTRICAL BUILDINGS	pag. 111	11
ELETTROSERRATURE E SISTEMI DI SICUREZZA HI-TECH ELECTROMECHANICAL SECURITY LOCK	pag. 115	12
COMPONENTI DI CIFRATURA KEYING KIT	pag. 139	13
DISEGNI E SPECIFICHE TECNICHE DRAWINGS AND TECHNICAL SPECIFICATIONS	pag. 145	14

7

SERRATURE PER SERRAMENTI IN ALLUMINIO
LOCKS FOR ALUMINIUM FRAMES
Art./Item: 720

Una mandata, due chiusure, frontale in acciaio inox
 One throw, two locking points, forend in stainless steel



In dotazione/equipped with:

- Coppia copritoppa in nylon
- Coppia attacchi aste filettati M8
- Viti di fissaggio
- Set of escutcheons in nylon
- M8 rods screwed connection
- Fixing screws

A richiesta/on request:

- Serie aste cod. 9999.00.11/9999.50.11
- Series of rods item 9999.00.11/9999.50.11

Cilindro da ordinare a parte
 Cylinder to be ordered separately

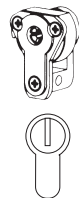

Frontale mm 22x3
 Forend mm 22x3

CODICE CODE	ENTRATA BACKSET		€
720.01.25	25	1	21,42
720.01.30	30	1	21,42
720.01.35	35	1	21,42
<hr/>			
760.01.25	25	1	21,76
760.01.30	30	1	21,76
760.01.35	35	1	21,76

Art./Item: 721

Una mandata e scrocco, tre chiusure, frontale in acciaio inox, scrocco reversibile
 One throw and latch, three locking points, forend in stainless steel, reversible latch



In dotazione/equipped with:

- Coppia copritoppa in nylon
- Coppia attacchi aste filettati M8
- Viti di fissaggio
- Set of escutcheons in nylon
- M8 rods screwed connection
- Fixing screws

A richiesta/on request:

- Serie aste cod. 9999.00.11/9999.50.11
- Controbordo regolabile cod. 200.00.0721.0022
- Series of rods item 9999.00.11/9999.50.11
- Adjustable strike item 200.00.0721.0022

Cilindro da ordinare a parte
 Cylinder to be ordered separately

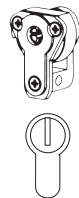

Frontale mm 22x3
 Forend mm 22x3

721.01.25	25	1	26,65
721.01.30	30	1	26,65
721.01.35	35	1	26,65
<hr/>			
761.01.25	25	1	26,98
761.01.30	30	1	26,98
761.01.35	35	1	26,98

Art./Item: 722

Una mandata, tre chiusure, frontale in acciaio inox, rullo regolabile
 One throw, three locking points, forend in stainless steel, adjustable roller catch



In dotazione/equipped with:

- Coppia copritoppa in nylon
- Coppia attacchi aste filettati M8
- Viti di fissaggio
- Set of escutcheons in nylon
- M8 rods screwed connection
- Fixing screws

A richiesta/on request:

- Serie aste cod. 9999.00.11/9999.50.11
- Controbordo regolabile cod. 200.00.0721.0022
- Series of rods item 9999.00.11/9999.50.11
- Adjustable strike item 200.00.0721.0022

Cilindro da ordinare a parte
 Cylinder to be ordered separately

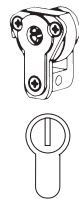

Frontale mm 22x3
 Forend mm 22x3

722.01.25	25	1	26,65
722.01.30	30	1	26,65
722.01.35	35	1	26,65
<hr/>			
762.01.25	25	1	26,98
762.01.30	30	1	26,98
762.01.35	35	1	26,98

SERRATURE PER SERRAMENTI IN ALLUMINIO LOCKS FOR ALUMINIUM FRAMES

7

Art./Item: 723**Una mandata, tre chiusure, frontale in acciaio inox**

One throw, three locking points, forend in stainless steel

**In dotazione/equipped with:**

- Coppia copritoppa in nylon
- Coppia attacchi aste filettati M8
- Viti di fissaggio
- Set of escutcheons in nylon
- M8 rods screwed connection
- Fixing screws

A richiesta/on request:

- Serie aste cod. 9999.00.11/9999.50.11
- Controbordo regolabile cod. 200.00.0721.0022
- Series of rods item 9999.00.11/9999.50.11
- Adjustable strike item 200.00.0721.0022

Cilindro da ordinare a parte
Cylinder to be ordered separately



Frontale mm 22x3
Forend mm 22x3

CODICE
CODE

ENTRATA
BACKSET



€

723.01.25	25	1	22,75
723.01.30	30	1	22,75
723.01.35	35	1	22,75
763.01.25	25	1	23,08
763.01.30	30	1	23,08
763.01.35	35	1	23,08

Art./Item: 724**Una mandata, tre chiusure, frontale in acciaio inox**

One throw, three locking points, forend in stainless steel

**In dotazione/equipped with:**

- Coppia copritoppa in nylon
- Coppia attacchi aste filettati M8
- Viti di fissaggio
- Set of escutcheons in nylon
- M8 rods screwed connection
- Fixing screws

A richiesta/on request:

- Serie aste cod. 9999.00.11/9999.50.11
- Controbordo regolabile cod. 200.00.0721.0022
- Series of rods item 9999.00.11/9999.50.11
- Adjustable strike item 200.00.0721.0022

Cilindro da ordinare a parte
Cylinder to be ordered separately

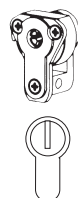

Frontale mm 22x3
Forend mm 22x3

724.01.25	25	1	22,75
724.01.30	30	1	22,75
724.01.35	35	1	22,75
764.01.25	25	1	23,08
764.01.30	30	1	23,08
764.01.35	35	1	23,08

7 SERRATURE PER SERRAMENTI IN ALLUMINIO LOCKS FOR ALUMINIUM FRAMES

Art./Item: 901 K entrata/backset = 16 mm

Art./Item: 901 KE entrata/backset = 21 mm

Una mandata, scrocco reversibile, frontale in acciaio nickelato

One throw, reversible latch, forend in steel, nickel-plated



In dotazione/equipped with:

- Coppia copritoppa in nylon
- Controbordo in acciaio nickelato
- Set of escutcheons in nylon
- Striking-plate in steel nickel-plated

n.1 KA
cod. 91.01.75

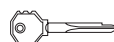

CODICE CODE	ENTRATA BACKSET	FRONTALE FOREND		€
901.31.16	16	16 mm	2	36,38
901.41.16	16	20 mm	2	36,38
901.31.21	21	20 mm	2	39,46
901.11.16	16	16 mm	2	32,23
901.21.16	16	20 mm	2	32,23
901.01.21	21	20 mm	2	35,31

Art./Item: 902 K entrata/backset = 16 mm

Art./Item: 902 KE entrata/backset = 21 mm

Una mandata, rullo regolabile, frontale in acciaio nickelato

One throw, adjustable roller catch, forend in steel, nickel-plated



In dotazione/equipped with:

- Coppia copritoppa in nylon
- Controbordo in acciaio nickelato
- Set of escutcheons in nylon
- Striking-plate in steel nickel-plated

n.1 KA
cod. 91.01.75



902.31.16	16	16 mm	2	36,38
902.41.16	16	20 mm	2	36,38
902.31.21	21	20 mm	2	39,46
902.11.16	16	16 mm	2	32,23
902.21.16	16	20 mm	2	32,23
902.01.21	21	20 mm	2	35,31

Art./Item: 903 K entrata/backset = 16 mm

Art./Item: 903 KE entrata/backset = 21 mm

Una mandata, frontale in acciaio nickelato

One throw, forend in steel, nickel-plated



In dotazione/equipped with:

- Coppia copritoppa in nylon
- Controbordo in acciaio nickelato (solo per confezione singola)
- Set of escutcheons in nylon
- Striking-plate in steel nickel-plated (Only for single package)

n.1 KA
cod. 91.01.75

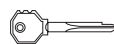

n.1 KA
cod. 91.01.75



n.3
cod. 91.01.75



n.2
cod. 91.01.75



903.31.16	16	16 mm	2	32,39
903.41.16	16	20 mm	2	32,39
903.31.21	21	20 mm	2	35,09
903.34.16	16	16 mm	12	25,16
903.44.16	16	20 mm	12	25,16
903.11.16	16	16 mm	2	28,24
903.21.16	16	20 mm	2	28,24
903.01.21	21	20 mm	2	30,94
903.14.16	16	16 mm	12	25,16
903.24.16	16	20 mm	12	25,16

SERRATURE PER SERRAMENTI IN ALLUMINIO LOCKS FOR ALUMINIUM FRAMES

7

Art./Item: 303 K**Catenaccio basculante, frontale in acciaio nickelato, cilindro originale FIAM**

Tipping bolt, forend in steel, nickel-plated, original FIAM cylinder



In dotazione/equipped with:

- Coppia copritoppa in nylon
- Controbordo in acciaio nickelato
- Viti di fissaggio
- Set of escutcheons in nylon
- Striking-plate in steel nickel-plated
- Fixing screws

n.2
cod. 91.01.75 

CODICE CODE	ENTRATA BACKSET		€
303.14.20	20	12	22,88
303.34.21	20	12	22,88
303.34.22	20	12	22,88
303.34.23	20	12	22,88
303.34.24	20	12	22,88
303.34.25	20	12	22,88

n.1 KA
cod. 91.01.75 Disponibili 5 gruppi KA compo-
sti da 12 serrature o multipliAvailable 5 KA groups with 12
locks or multiple of it**Art./Item: 304 K****Gancio basculante, frontale in acciaio nickelato, cilindro originale FIAM**

Backing hook bolt, forend in steel, nickel-plated, original FIAM cylinder



In dotazione/equipped with:

- Coppia copritoppa in nylon
- Controbordo in acciaio nickelato
- Viti di fissaggio
- Set of escutcheons in nylon
- Striking-plate in steel nickel-plated
- Fixing screws

n.2
cod. 91.01.75 n.1 KA
cod. 91.01.75 Disponibili 5 gruppi KA compo-
sti da 12 serrature o multipliAvailable 5 KA groups with 12
locks or multiple of it

304.14.20	20	12	22,88
304.34.21	20	12	22,88
304.34.22	20	12	22,88
304.34.23	20	12	22,88
304.34.24	20	12	22,88
304.34.25	20	12	22,88

Art./Item: 931**Due mandate e scrocco, 3 chiusure, frontale in acciaio inox mm 22x3, sporgenza scrocco regolabile, zincata**

Two throws and latch, three locking points, forend in stainless steel mm 22x3, adjustable latch projection, zinc-plated



In dotazione/equipped with:

- Coppia attacchi aste filettati M8
- Coppia copritoppa in nylon
- Viti di fissaggio
- M8 rods screwed connection
- Set of escutcheons in nylon
- Fixing screws

A richiesta/on request:

- Serie aste cod. 9999.00.11/9999.50.11
- Rods code series 9999.00.11/9999.50.11



Cilindro in dotazione

Cod. F20930303N F3

Cylinder included
Item F20930303N F3

931.00.90	90	1	49,22
-----------	----	---	-------

7

SERRATURE PER SERRAMENTI IN ALLUMINIO

LOCKS FOR ALUMINIUM FRAMES

EXIT Tipo/Type **A**

Tre catenacci laterali autobloccanti
Scrocco reversibile in ottone nickelato
Frontale inox mm 2300

Three lateral self-blocking bolts
Reversible latch in nickel-plated brass
Forend 2300 mm in stainless steel

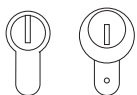
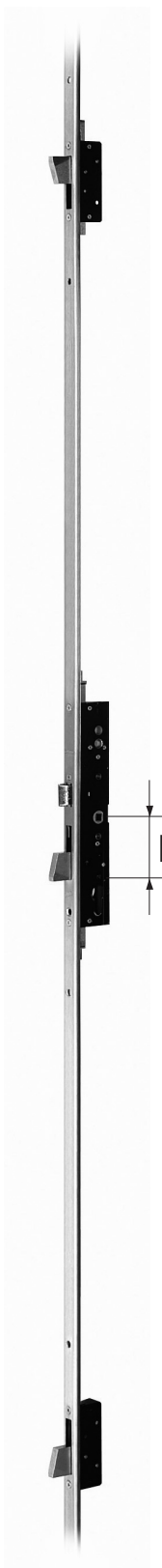

Disponibile con interasse
85, 92 e 94 mm

Available with 85, 92
and 94 mm interaxle

INGRESSO DALL'ESTERNO CON CHIAVE

La porta potrà essere aperta dall'esterno unicamente da persone autorizzate

ACCESS FROM OUTSIDE BY KEY

The door can be opened from outside by authorised persons only

FUNZIONAMENTO/HOW IT WORKS

DALL'INTERNO

- Maniglione antipanico per aprire
- Chiave per aprire e chiudere con i catenacci

FROM INSIDE

- Panic device system to open
- Key to open and close with bolts

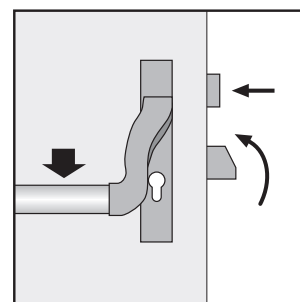

DALL'ESTERNO

- La chiave aziona lo scrocco ed i catenacci sia in chiusura che in apertura

FROM OUTSIDE

- The key manoeuvres the latch and the bolts both when opening and when closing

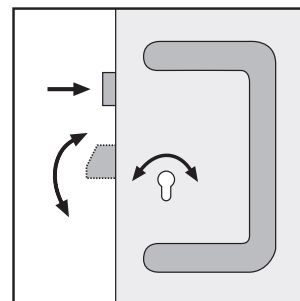

FIAM S.r.l.
via Don G. Fasola, 4
22069 Fovellasca -CO-
Italy

03



0099 - A440097

UNI EN1125:97+A1:2001 3|7|5|0|1|3|2|1|A

MICROSWITCH DI CONTROLLO/LOCK STATUS MICROSWITCH

CODICE/CODE	DESCRIZIONE/DESCRIPTION	EXIT	TOP EXIT	€
S	Scrocco/Latch	○	●	16,94
B	Catenaccio/Dead bolt	○	○	16,94
C	Cilindro/Cylinder	○	○	28,44
K	Scrocco e catenaccio/Latch and dead bolt	○	○	33,89
X	Scrocco,catenaccio e cilindro/Latch, dead bolt and cylinder	○	○	57,78

● = *di serie/standard*

○ = *a richiesta/on request*

Per ordinare la serratura comprensiva dei microswitch di controllo aggiungere al codice della serratura l'identificativo sopra riportato. Esempio: 1741.28.85B Top Exit E 35 I 85 con micro controllo catenaccio.

If you wish order the lock endowed with status microswitch, please add the above codes. Example: 1741.28.85B Top Exit E 35 I 85 with bolt microswitch.

SERRATURE PER SERRAMENTI IN ALLUMINIO LOCKS FOR ALUMINIUM FRAMES

7

EXIT

Conforme alle norme UNI EN 1125

Approved according to UNI EN 1125 norms

Serrature laterali

Single locking point

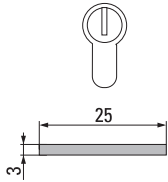
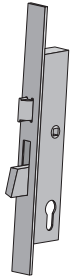

In dotazione/equipped with:

- Coppia copritoppa in nylon
- Quadro maniglia L 100 mm
- Vite di fissaggio
- Set of escutcheons in nylon
- Square handle pin L 100 mm
- Fixing screws

CODICE
CODE

ENTRATA
BACKSET

INTERASSE
INTERAXLE

MANO
HAND



0721.38.85	30	85	-	8	1	122,10
0721.18.85	35	85	-	8	1	122,10

Serrature multipunto

Three locking point

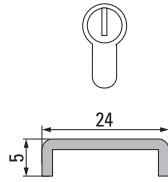
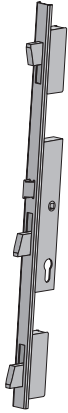

1741.38.85	30	85	-	8	1	133,12
1741.18.85	35	85	-	8	1	133,12

TOP EXIT

Conforme alle norme UNI EN 1125 e pr EN 12209

Approved according to UNI EN 1125 and EN 12209 norms

Serrature laterali

Single locking point

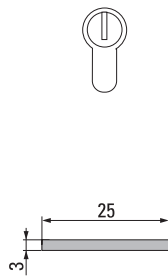
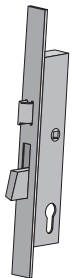

In dotazione/equipped with:

- Coppia copritoppa in nylon
- Quadro maniglia L 100 mm
- Vite di fissaggio
- Set of escutcheons in nylon
- Square handle pin L 100 mm
- Fixing screws

0721.28.85	35	85	-	8	1	356,72
------------	----	----	---	---	---	--------

Serrature multipunto

Three locking point

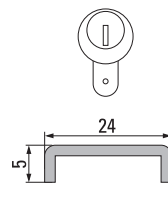
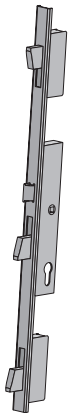

1741.29.94	35	94	-	9	1	412,06
------------	----	----	---	---	---	--------

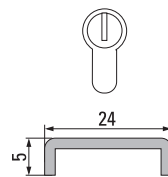

1741.28.85	35	85	-	8	1	389,24
1741.29.92	35	92	-	9	1	389,24

La conformità alla normativa UNI EN 1125 è garantita unicamente con l'installazione del kit completo, vale a dire serratura, maniglione antipanico articolo 949 e set contropiastre cod. 98.1741.00.

UNI EN 1125 norm is guaranteed on condition that the whole kit is installed, in other words: lock, panic device system item 949, and set of striking-plates item. 98.1741.00.

7

SERRATURE PER SERRAMENTI IN ALLUMINIO

LOCKS FOR ALUMINIUM FRAMES

EXIT Tipo/Type **B**

Tre catenacci laterali autobloccanti
Scrocco in ottone nickelato
Frontale inox mm 2300

Three lateral self-blocking bolts
Latch in nickel-plated brass
Forend 2300 mm in stainless steel



MANIGLIA ESTERNA ABILITATA O DISABILITATA

Dall'esterno è consentito l'ingresso libero quando i catenacci sono arretrati. Inoltre la porta potrà essere aperta dall'esterno unicamente da persone autorizzate munite di chiavi allorchè la serratura si trova in posizione di sicurezza ossia con catenacci abbassati.

EXTERNAL HANDLE IN OR OUT OF SERVICE

Access permitted from outside when bolts are withdrawn. Instead, the door can be opened from outside only by authorised persons who have a key and when lock is in the safety position, i.e. with bolts down.

FUNZIONAMENTO/HOW IT WORKS

DALL'INTERNO

- Maniglione antipanico per aprire
- Chiave per aprire e chiudere con i catenacci

FROM INSIDE

- Panic device system to open
- Key to open and close with bolts

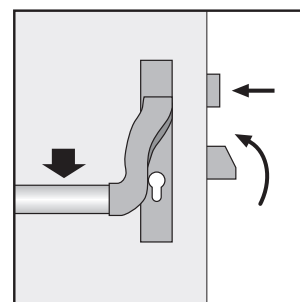

DALL'ESTERNO

- La chiave aziona lo scrocco ed i catenacci sia in chiusura che in apertura.
- La maniglia, con catenacci arretrati, abilita al comando dello scrocco.

FROM OUTSIDE

- Key manoeuvres bolts and latch both when closing and when opening.
- The handle, when bolts are withdrawn, operates on the latch.

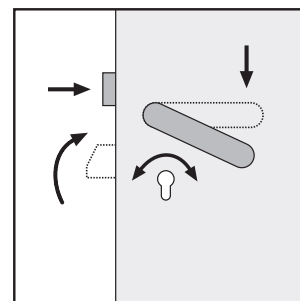

FIAM S.r.l. via Don G. Fasola, 4 22069 Fovellasca -CO- Italy	03	ICIM	CE 0099 - A440097
UNI EN1125:97+A1:2001	3 7 5 0 1 3 2 1 A		

MICROSWITCH DI CONTROLLO/LOCK STATUS MICROSWITCH

CODICE/CODE	DESCRIZIONE/DESCRIPTION	EXIT	TOP EXIT	€
S	Scrocco/Latch	○	●	16,94
B	Catenaccio/Dead bolt	○	○	16,94
C	Cilindro/Cylinder	○	○	28,44
K	Scrocco e catenaccio/Latch and dead bolt	○	○	33,89
X	Scrocco,catenaccio e cilindro/Latch, dead bolt and cylinder	○	○	57,78

● = *di serie/standard*

○ = *a richiesta/on request*

Per ordinare la serratura comprensiva dei microswitch di controllo aggiungere al codice della serratura l'identificativo sopra riportato. Esempio: 1741.28.85K1 Top Exit E 35 I 85, destra, con micro controllo scrocco e catenaccio.

If you wish order the lock endowed with status microswitch, please add the above codes. Example: 1741.28.85K1 Top Exit E 35 I 85, right hand, with bolt and latch microswitch.

SERRATURE PER SERRAMENTI IN ALLUMINIO LOCKS FOR ALUMINIUM FRAMES

7

EXIT

Conforme alle norme UNI EN 1125

Approved according to UNI EN 1125 norms

Serrature laterali

Single locking point

In dotazione/equipped with:

- Coppia copritoppa in nylon
- Quadro maniglia L 100 mm
- Vite di fissaggio
- Set of escutcheons in nylon
- Square handle pin L 100 mm
- Fixing screws

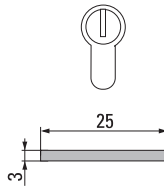
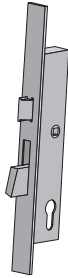

CODICE CODE	ENTRATA BACKSET	INTERASSE INTERAXLE	MANO HAND			€
0721.38.8501	30	85	DX	8	1	122,10
0721.38.8502	30	85	SX	8	1	122,10
0721.18.8501	35	85	DX	8	1	122,10
0721.18.8502	35	85	SX	8	1	122,10

Serrature multipunto

Three locking point

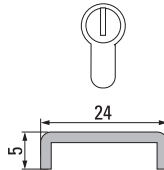
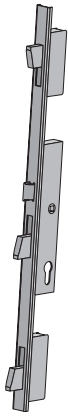

1741.38.8501	30	85	DX	8	1	133,12
1741.38.8502	30	85	SX	8	1	133,12
1741.18.8501	35	85	DX	8	1	133,12
1741.18.8502	35	85	SX	8	1	133,12

TOP EXIT

Conforme alle norme UNI EN 1125 e pr EN 12209

Approved according to UNI EN 1125 and EN 12209 norms

Serrature laterali

Single locking point

In dotazione/equipped with:

- Coppia copritoppa in nylon
- Quadro maniglia L 100 mm
- Vite di fissaggio
- Set of escutcheons in nylon
- Square handle pin L 100 mm
- Fixing screws

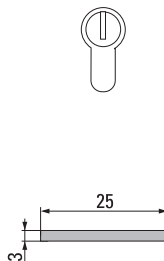
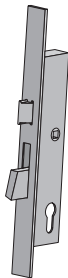

0721.28.8501	35	85	DX	8	1	356,72
0721.28.8502	35	85	SX	8	1	356,72

Serrature multipunto

Three locking point

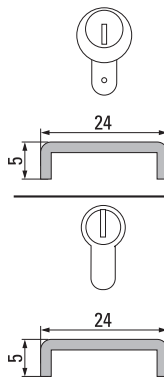
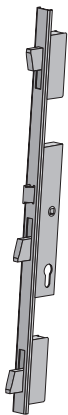

1741.29.9401	35	94	DX	9	1	412,06
1741.29.9402	35	94	SX	9	1	412,06
1741.28.8501	35	85	DX	8	1	389,24
1741.28.8502	35	85	SX	8	1	389,24
1741.29.9201	35	92	DX	9	1	389,24
1741.29.9202	35	92	SX	9	1	389,24

La conformità alla normativa UNI EN 1125 è garantita unicamente con l'installazione del kit completo, vale a dire serratura, maniglione antipanico articolo 949 e set contropiastre cod. 98.1741.00.

UNI EN 1125 norm is guaranteed on condition that the whole kit is installed, in other words: lock, panic device system item 949, and set of striking-plates item. 98.1741.00.

7

SERRATURE PER SERRAMENTI IN ALLUMINIO
LOCKS FOR ALUMINIUM FRAMES
Art./Item: 949**In acciaio, con cover in lega di alluminio verniciato, reversibile, barra in acciaio colore rosso**

In steel, with aluminium alloy varnished cover, reversible, red steel bar



	CODICE CODE	INTERASSE INTERAXLE			€
Meccanismi laterali Lateral devices	949.0000.5048	85	8	1	72,11
	949.0000.5049	92	9	1	72,11
Barra L 1130 colore grigio Barr L 1130 gray color	945.923	-	-	1	13,83
Barra L 1130 colore rosso Barr L 1130 red color	945.928	-	-	1	13,83
Barra L 1330 colore rosso Barr L 1330 red color	945.938	-	-	1	18,41

per articolo/for item

per serrature serie EXIT
EXIT series locks**Set contropiastre, in acciaio inox, regolabili e reversibili**

Set of striking-plates, in stainless steel, adjustable and reversible



Serrature multipunto Multi point locks UNI EN 1125	98.1741.00	-	-	1	42,30
Serrature laterali Lateral locks UNI EN 1125	200.00.1741.2000	-	-	1	33,60
Standard	98.1741.01	-	-	1	20,48

per articolo/for item

per serrature serie EXIT
EXIT series locks**IRON****In acciaio temprato****Finitura: nickelato opaco (NKM), elettroverniciato nero (EVN), ottone lucido (OLV)****Completo di rosetta interna, in nylon e viti di fissaggio**

In tempered steel

Finish: nickel matt (NKM), electrovarnished, black (EVN), polished brass (OLV)

Internal escutcheon, in nylon and fixing screws included

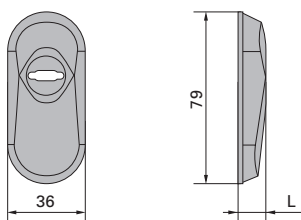

98.05.0204	16	NKM	6	33,38
98.05.0205	16	EVN	6	33,38
98.05.0206	16	OLV	6	34,65
98.05.0104	12	NKM	6	33,38
98.05.0105	12	EVN	6	33,38
98.05.0106	12	OLV	6	34,65

SERRATURE PER SERRAMENTI IN ALLUMINIO LOCKS FOR ALUMINIUM FRAMES

7

Asta, attacco filettato M8 in acciaio zincato

M8 rod screwed connection in steel zinc plated

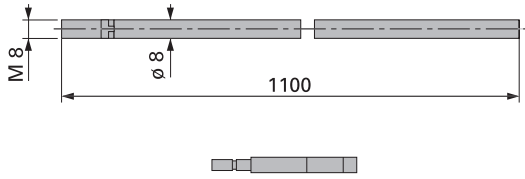

Confezione industriale senza puntale/Industrial package without tip

CODICE CODE	MANO HAND	TIPO TYPE		€
9999.50.11	-	-	50	3,79
9999.00.11	-	-	10	5,18

Con puntale antisega Ø 8 mm/With anti-saw tip Ø 8 mm

Asta, attacco speciale a scatto in acciaio zincato

Special rod fixing tips in steel zinc plated

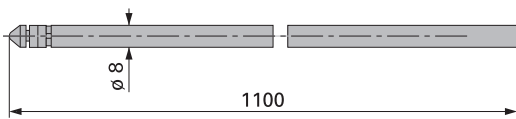

Confezione industriale senza puntale/Industrial package without tip

9999.50.26	-	-	50	3,79
9999.00.26	-	-	10	5,18

Con puntale antisega Ø 8 mm/With anti-saw tip Ø 8 mm

Puntale per asta in acciaio cementato, taglio cacciavite, due diametri disponibili: Ø10 e Ø12

Rod tips, in cemented steel, screw-driver cut, two diameters available: Ø 10mm and Ø 12mm

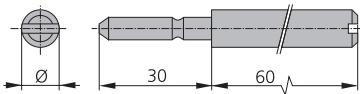

9999.71.01	-	Ø10	50	2,01
9999.71.21	-	Ø12	50	2,22

Controbordo in acciaio inox

Strike-plate in Stainless Steel

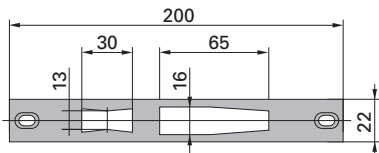

per articolo/for item

0721
0722

200.00.0721.0000	-	-	12	5,16
------------------	---	---	----	------

Controbordo

Strike-plate

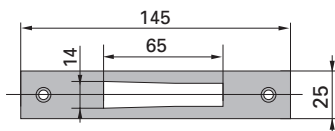

per articolo/for item

0713
0714
0723
0724

Acciaio Inox/Stainless steel

200.00.0726.0000	-	-	12	4,77
------------------	---	---	----	------

Ferro zincato/Zinc plated iron

200.00.0716.0200	-	-	12	2,80
------------------	---	---	----	------

7

SERRATURE PER SERRAMENTI IN ALLUMINIO
LOCKS FOR ALUMINIUM FRAMES
Controbordo in acciaio zincato

Strike-plate in steel, zinc-plated

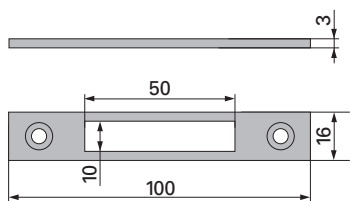
 per articolo/for item
903K

 CODICE
 CODE

 INTERASSE
 INTERAXLE

200.00.0903.0016	-	-	12	2,80
------------------	---	---	----	------

**Controbordo regolabile
 in acciaio inox**

Adjustable strike plate in stainless steel

 per articolo/for item
 per serrature serie 700 e EXIT
 700 and EXIT series locks

200.00.0721.0022	-	-	6	9,02
------------------	---	---	---	------

**Controbordo regolabile
 in acciaio inox**

Adjustable strike plate in stainless steel

 per articolo/for item
 per serrature serie EXIT
 EXIT series locks

98.1741.05	-	-	6	16,61
------------	---	---	---	-------