

INDICE CATEGORICO CATEGORIC INDEX	pag. 2	A
INDICE ANALITICO ANALYTIC INDEX	pag. 4	B
CONDIZIONI DI VENDITA SALES CONDITIONS	pag. 10	C
MAGGIORAZIONI PER IMPIANTI SPECIALI EXTRA CHARGES FOR KEYING ARRANGEMENTS	pag. 12	D
CHIAVI KEYS	pag. 15	1
CILINDRI CYLINDERS	pag. 19	2
MOSTRINE E PROTEZIONI PER CILINDRO ESCUTCHEONS AND CYLINDER PROTECTIONS	pag. 25	3
SERRATURE PER PORTE BLINDATE LOCKS FOR ARMoured DOORS	pag. 31	4
SERRATURE DA INFILARE CON CHIAVI A DOPPIA MAPPA MORTICE LOCKS WITH DOUBLE BITTED KEYS	pag. 71	5
SERRATURE DA INFILARE A CILINDRO MORTICE LOCKS WITH CYLINDER	pag. 77	6
SERRATURE PER SERRAMENTI IN ALLUMINIO LOCKS FOR ALUMINIUM FRAMES	pag. 85	7
SERRATURE PER SERRAMENTI IN FERRO LOCKS FOR IRON FRAMES	pag. 97	8
SERRATURE PER PORTE E CANCELLI SCORREVOLI LOCKS FOR SLIDING DOORS AND GATES	pag. 103	9
SERRATURE PER PORTE E SERRANDE BASCULANTI ROLLER SHUTTER LOCKS	pag. 107	10
CHIUSURE PER CABINE ELETTRICHE LOCKS FOR ELECTRICAL BUILDINGS	pag. 111	11
ELETTROSERRATURE E SISTEMI DI SICUREZZA HI-TECH ELECTROMECHANICAL SECURITY LOCK	pag. 115	12
COMPONENTI DI CIFRATURA KEYING KIT	pag. 139	13
DISEGNI E SPECIFICHE TECNICHE DRAWINGS AND TECHNICAL SPECIFICATIONS	pag. 145	14

10 SERRATURE PER PORTE E SERRANDE BASCULANTI

ROLLER SHUTTER LOCKS

Art./Item: 102**Due mandate, centrale, movimento comandato dalla maniglia**

Two throws, central, movement controlled by handle

n.3
cod. 34.00.65CODICE
CODEENTRATA
BACKSET

€

102.00.00

-

2

44,74

n.3 KA
cod. 34.00.65

102.00.01

-

2

63,42

Art./Item: 105**Due mandate, centrale**

Two throws, central

n.3
cod. 34.00.65

105.00.00

-

2

28,04

Art./Item: 107**Due mandate, laterale**

Two throws, lateral

n.2
cod. 34.00.65

107.00.01

DX

2

27,30

107.00.02

SX

2

27,30

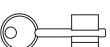
Serrature accoppiate/
coupled locksn.2 KA
cod. 34.00.65

107.01.00

-

1

50,90

SERRATURE PER PORTE E SERRANDE BASCULANTI ROLLER SHUTTER LOCKS

10

Art./Item: 109 KC

Una mandata, centrale

One throw, central

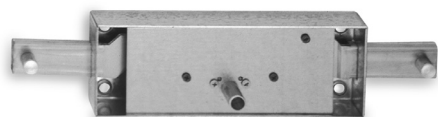

n.3
cod. 91.01.75 

CODICE CODE	ENTRATA BACKSET		€
1091.00.03	-	2	34,23
1091.00.13	-	2	40,03

n.3
cod. 91.01.10 

Art./Item: 109 K

Una mandata, laterale

One throw, lateral

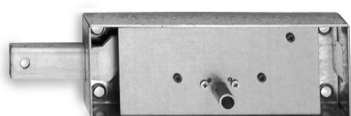

n.3
cod. 91.01.75 

1091.00.01	DX	2	32,75
1091.00.02	SX	2	32,75
Serrature accoppiate/ coupled locks			
n.3 KA cod. 91.01.75 			
1091.01.00	-	1	61,51

Art./Item: GARAGE DOOR

Completa di aste, guida aste e box di fissaggio

With rods, rod guides and lock support

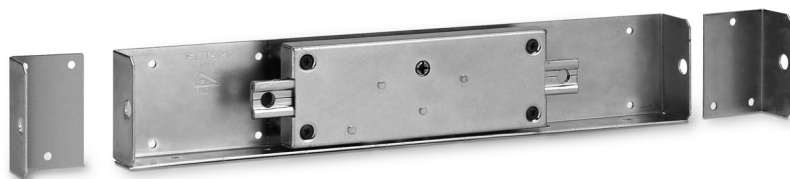

1091.02.00	-	1	52,18
------------	---	---	-------

10 ACCESSORI ACCESSORIES

Deviatore centrale da applicare, doppio rinvio

Rim central deviator, double rods deviator

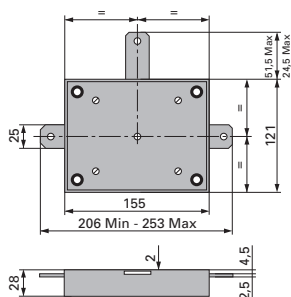

per articolo/for item
102

CODICE
CODE

ENTRATA
BACKSET



103.00.00

-

1

31,73

Piastra di fissaggio in acciaio

Supporting plate in steel

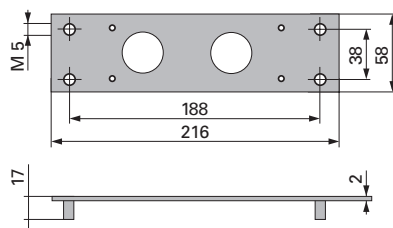

per articolo/for item
102.00.00

9999.00.32

-

1

7,02

Piastra di fissaggio in acciaio

Supporting plate in steel

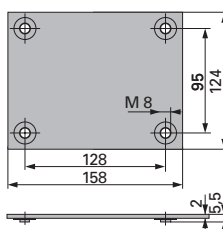

per articolo/for item
103.00.00

9999.00.31

-

1

5,96

Serie aste per applicazioni a due chiusure, zincate

Series of rods for two closure locks, zinc-plated

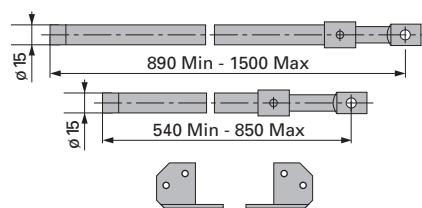

per articolo/for item
102.00.00

9999.00.08

-

1

40,97

Serie aste per applicazioni a tre chiusure, zincate

Series of rods for three closure locks, zinc-plated

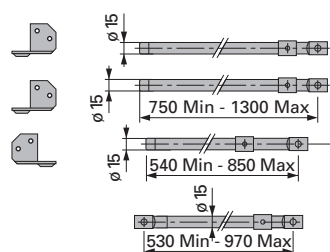

per articolo/for item
102.00.00
103.00.00

9999.00.07

-

1

53,52